

ISSUE	DESCRIPTION	DATE
V00	初始版本	

1	LED-
2	LED+
3	GND
4	VDD
5	RO
6	R1
7	R2
8	R3
9	R4
10	R5
11	R6
12	R7
13	G0
14	G1
15	G2
16	G3
17	G4
18	G5
19	G6
20	G7
21	B0
22	B1
23	B2
24	B3
25	B4
26	B5
27	B6
28	B7
29	GND
30	DCLK
31	DISP
32	HS
33	VS
34	DE
35	NC
36	GND
37	XR(X+)/NC
38	YD(Y-)/NC
39	XI(X-)/NC
40	YI(Y+)/NC

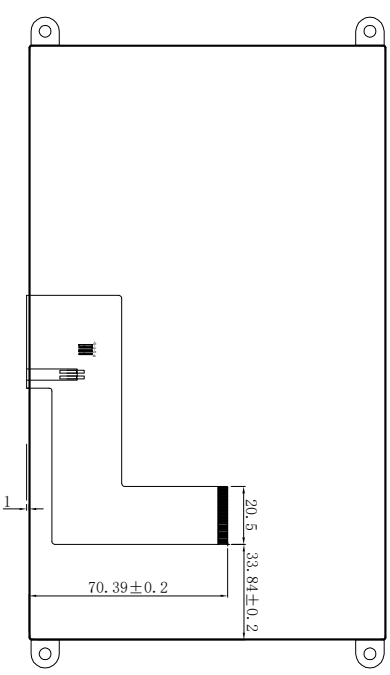

CIRCUIT DIAGRAM (LED 3X11=33 dies)

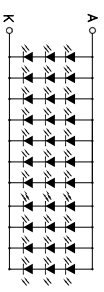

- NOTES:
1. Display: CMI 9.0" WGA (TN) ;
 2. Driver IC:
 3. STORAGE TEMPERATURE: -30° C TO 80° C ;
 4. OPERATING TEMPERATURE: -20° C TO 70° C ;
 5. BL LED: 6 CHIP-WHITE LEDS SERIES*3, IF=60mA ;
 6. LCM Brightness: 500cd/m2 (MIN), 530cd/m2 (typ) ;
 7. CHROMATICITY COORDINATE: X: 0.31±0.03
 8. Y: 0.32±0.03
 9. ** CRITICAL DIMENSION: () REFERENCE DIMENSION;
 10. RECOMMENDED CELLPHONE WINDOW SIZE: 0.5mm FROM LCD A, A AREA ;
 11. LCD warp is ≤ 0.3;
 12. 偏光片上雾42%, 下雾25%.
 13. 符合一级环境禁用管理物质。

UNIT: A4	SCALE: mm	SIZE: NO SCALE	DATE	PART NO.	SHEET: 1/1
GENERAL: ±0.2	ANGLE: 1°		DATE		REV: 00
TOLERANCE:			DATE		
DESIGNED: Alice			DATE		
CHECKED:			DATE		
APPROVED:			DATE		