

Rev	Notes	Date	Engineering Checked
1			
2			
3			

Pin	Description
1	GND
2	GND/(SSDA)
3	IM0
4	FMARK
5	YD
6	XL
7	RESET
8	RS((SCL))
9	CS
10	RD
11	VR(D/C)
12	VCC
13	NC/(SSDD)
14	GND
15	DB15/(GND)
16	DB14/(GND)
17	DB13/(GND)
18	DB12/(GND)
19	DB11/(GND)
20	DB10/(GND)
21	DB9/(GND)
22	DB8/(GND)
23	DB7/(GND)
24	DB6/(GND)
25	DB0/(GND)
26	DB1/(GND)
27	DB2/(GND)
28	DB3/(GND)
29	DB4/(GND)
30	DB5/(GND)
31	YU
32	XR
33	LEDA
34	LEDK1
35	LEDK2
36	LEDK3
37	LEDK4
38	NC
39	NC
40	GND

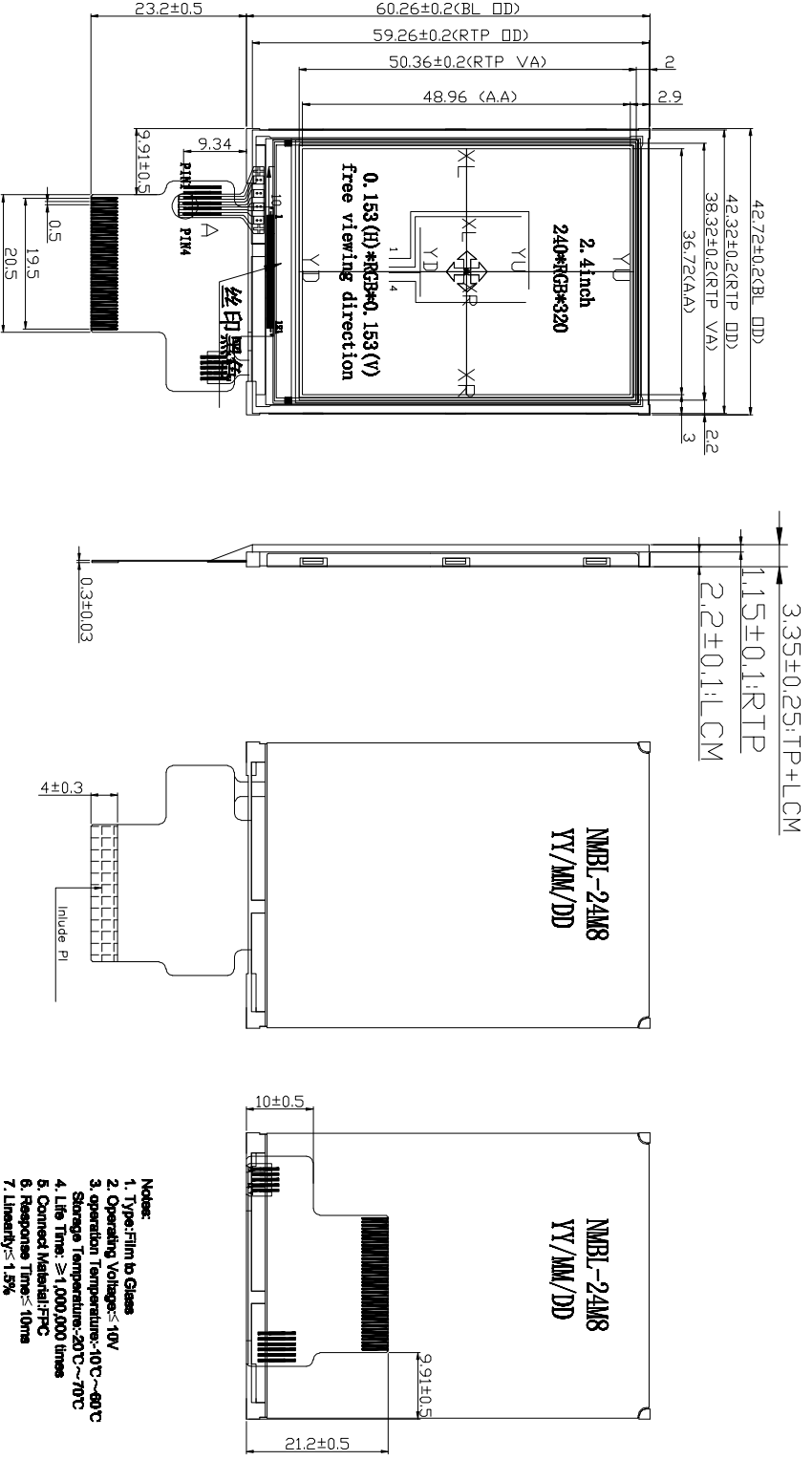

IM0=0, MCU16-bit, DB0~DB15;
IM0=1, 4line spi

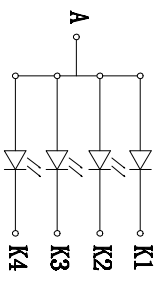

LED CIRCUIT DIAGRAM:

- Notes:
1. Type: Film to Glass
 2. Operating Voltage: ≤10V
 3. operation Temperature: -10°C~80°C
 4. Life Time: ≥1,000,000 times
 5. Storage Temperature: -20°C~70°C
 6. Connect Material: FPC
 7. Response Time: ≤10ms
 8. Linearity: ≤1.5%
 9. Transmittance: ≥80%
 10. Surface Hardness: ≥3H(Fencil)
 11. operation force: 50g~120g
 12. Resistance: (Clear Hard ITO/Film) k:1500~5000 (Stand and ITO/Glass) k:500~8500
 13. 红色标注尺寸为重点确认项。

LCD Type	2.4" TFT, Transmissive, Normally black, IPS
Resolution	240*(RGB)*320
Viewing Angle	ALL
Driver IC	ST7789V
Color Depth	262K
Interface Types	MCUB-16-bit
Backlight Types	4 LEDs
Operating temperature	-20 C° ~70 C°
Storage Temperature	-30 C° ~80 C°
Storage Humidity	10RH ~ 40RH

NO.	SYMBOL
1	YU
2	XL
3	YD
4	XR

Limits Unless Otherwise Noted	Tolerance Grade		设计	签名	日期
	Grade	Symbol			
0 - 150	±0.10	±0.15	±0.20	审核	
150+	±0.20	±0.25	±0.30	批准	
Angle	±0.50°	±0.80°		客户确认	

材料		4D SYSTEMS PTY LTD	
单位	mm	客户图号	4DLCD-24240320-TPS-RTP
比例	1:1	工程图号	NMLCD-24M7
日期	20210622	投影法	第一角
		版本	1.0